

圖例 Legend

- ↔ 行車方向 Traffic Direction
- ⊗ ⊗ Temporary Closure of the Slip Road leading from Fo Tan Road to Tai Po Road – Sha Tin Section (Southbound) (Kowloon and Tsuen Wan Direction)
- ↗ Alternative Route of Left turn movement from Fo Tan Road (Northbound) to Tai Po Road - Sha Tin Section (Southbound)
- ↘ Alternative Route of Right turn movement from Fo Tan Road (Southbound) to Tai Po Road - Sha Tin Section (Southbound)
- ↖ Alternative Route of Left turn movement from Yuen Wo Road to Fo Tan Road westbound

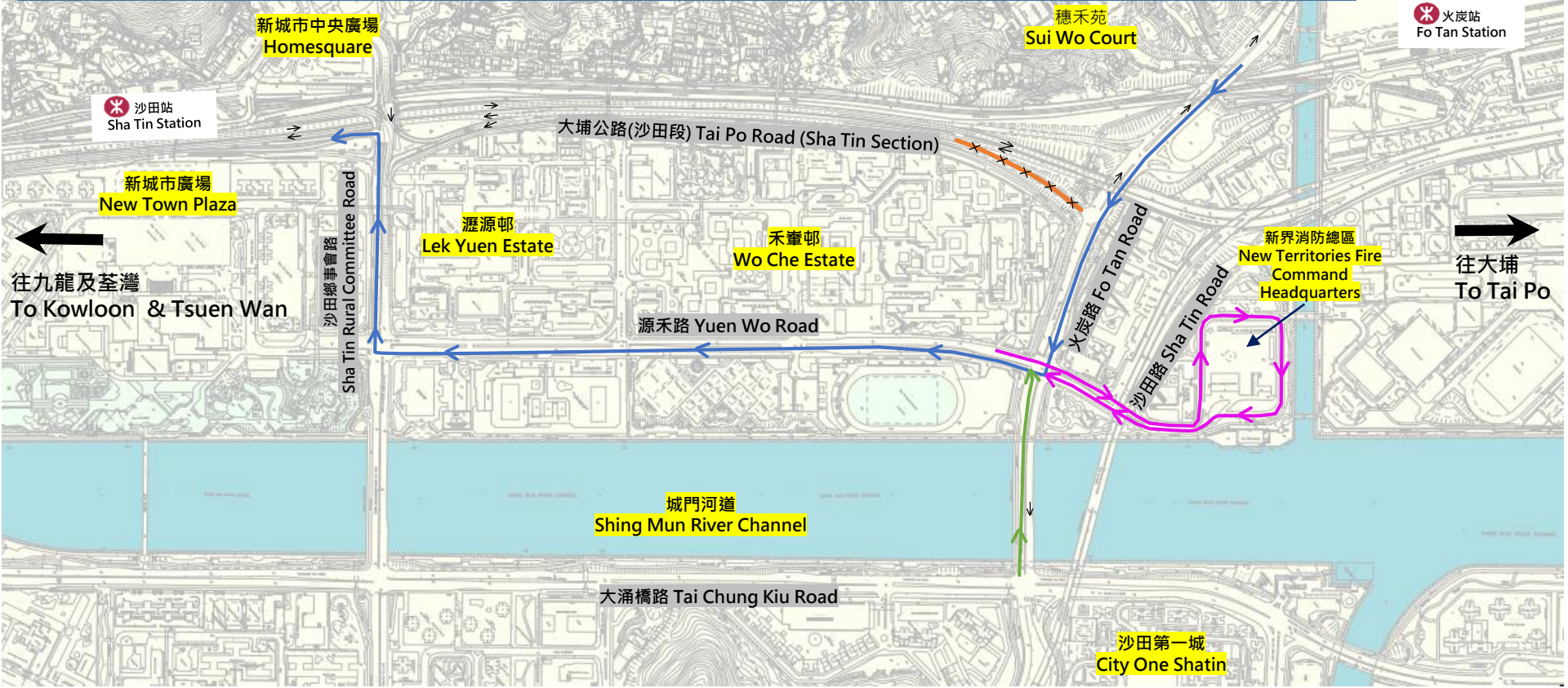

由火炭路通往大埔公路 - 沙田段 (南行) 支路往九龍及荃灣方向行車線 臨時封閉及替代路線
 實施日期：2024年10月19及26日，凌晨0時30分至早上5時

Temporary Closure of the Slip Road Leading from Fo Tan Road to Kowloon and Tsuen Wan Direction of Tai Po Road – Sha Tin (Southbound) with Alternative Route
 Implementation Period : 00:30 a.m. to 5:00 a.m. on 19 & 26 September 2024

附圖
Figure